

Verlängerungen für Messuhren-Satz Extensions for dial indicators SET

AUSFÜHRUNG

- für Messuhren mit Gewinde M 2,5
- 10/15/20/25/30/40/50/80/100 mm
- Ø 4 mm
- Spezialstahl
- inkl. Etui

FEATURES

- for dial indicators thread M 2,5
- 10/15/20/25/30/40/50/80/100 mm
- Ø 4 mm
- special steel
- incl. box

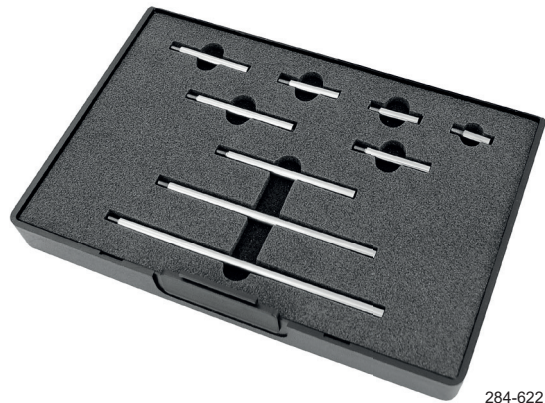

284-622

Verlängerungen für Messuhren-Satz Extensions for dial indicators SET

AUSFÜHRUNG

- mit Gewinde M 2,5
- Ø 4 mm

FEATURES

- thread M 2,5
- Ø 4 mm



Messbereich	Best.-Nr.
Range	Code No.
10mm	284-601
15mm	284-602
20mm	284-603
25mm	284-604

Messbereich	Best.-Nr.
Range	Code No.
30mm	284-605
35mm	284-606
40mm	284-607
45mm	284-608

Messbereich	Best.-Nr.
Range	Code No.
50mm	284-609
55mm	284-611
60mm	284-612
65mm	284-613

Messbereich	Best.-Nr.
Range	Code No.
70mm	284-614
75mm	284-615
80mm	284-616
85mm	284-617

Messbereich	Best.-Nr.
Range	Code No.
90mm	284-618
95mm	284-619
100mm	284-621

Verlängerungen für Messuhren-Satz Extensions for dial indicators SET

AUSFÜHRUNG

- mit Gewinde M 2,5

FEATURES

- thread M 2,5

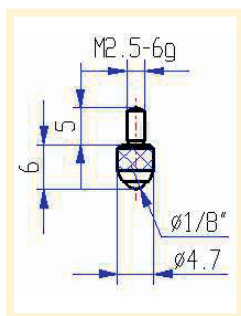

284-40

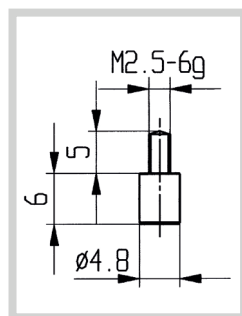

284-41

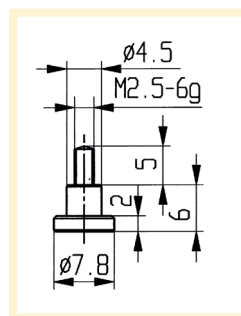

284-42

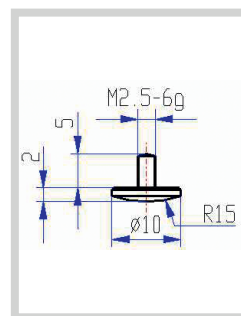

284-43

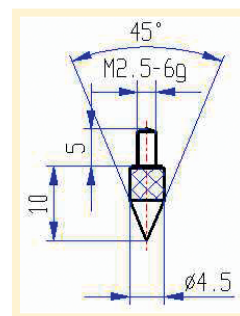

284-44

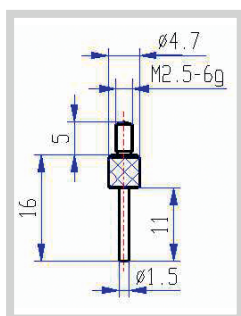

284-45

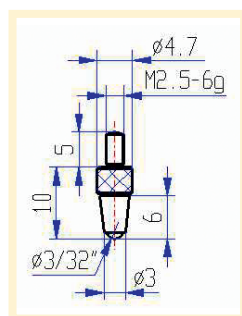

284-46

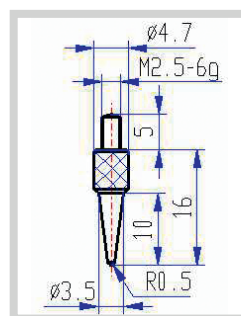

284-47

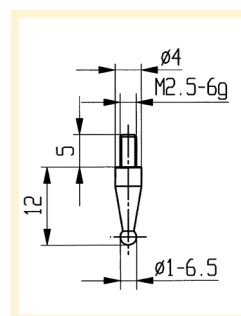

284-48*

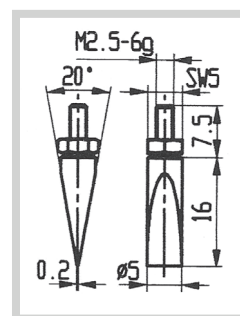

284-49

* Kugeldurchmesser bitte angeben
* please name the ball diameter