

## Dial indicator

### FEATURES

- High contrast dial face
- Adjustable tolerance markers
- Chrome plated housing
- Lifter protection cap on the measuring spindle
- Precision gears and pinions
- Package contains: case

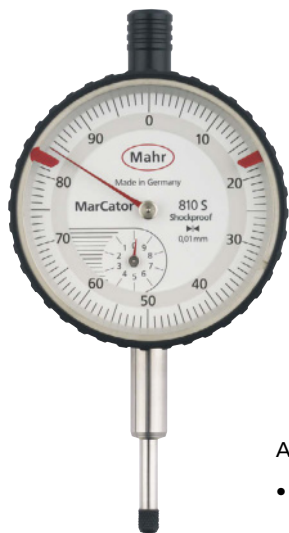

### Application:

- 810 AU: The measuring pin is retracted by spring, contacting and the measuring force are triggered manually by pressing on the upper sleeve

### TECHNICAL DATA

Order no.		4311000	4311050	4311060	4321000	4329050
Type		810 S	810 A	810 AT	810 SV	810 AU
Measuring span	mm		10		40	10
Readings	mm			0.01		
Type of dial face		0–100		100–0	0–100	100–0
Error limit, measuring range	µm		15		25	15
Error limit, 1 revolution	µm		10		15	10
Error limit, 1/2 revolution	µm		9		10	9
Error limit, 1/10 revolution	µm			5		
Repeatability $f_w$	µm		3			5
Measuring value hysteresis $f_u$	µm		3		6	
Free stroke	mm	0.1		0.8		0.1
Generation of measuring force						manual
Measuring force incoming measuring pin	N		0.7–1.3		0.8–1.8	-
Standard			DIN 878			Factory standard
Shockproof movement		•			•	
Lifting protection cap				•		
Reverse measuring force direction						•
Scale diameter	mm			50		
Range per turn	mm			1		
Dial color				White		

Order no.	a	b	c	d	e	f	g	Mounting shaft
	mm	mm	mm	mm	mm	mm	mm	mm
4311000	58	23	7.5	52	112	21	16	8
4311050	58	23	7.5	52	112	22	15	8
4311060	58	23	7.5	52	112	22	15	8
4321000	58	24.2	8.7	52	169	22	45	8
4329050	58	23	7.5	52	112	22	4.5	8

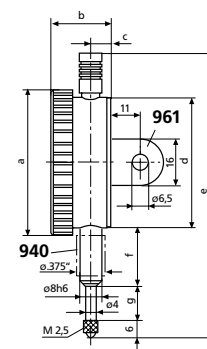

### ACCESSORIES

Order no.	Description	Type
4310103	Adapter bushing (.375" / 8 mm)	940
4373020	Splash proof cap (58 mm)	955
4375010	Lug back, vertical, for 810	961
4375011	Lug back, horizontal, for 810	962