

# Millimess 1000 A / 1000 B

## Dial comparator

### FEATURES

- Large, high contrast dial face
- Adjustable tolerance markers
- Lockable fine adjustment screw
- Shockproof movement
- Mounting shank and measuring spindle are both made of hardened stainless steel
- Measuring spindle is mounted in a high precision ball guide for minimal hysteresis
- Resistant to lateral forces (side play) acting on the measuring spindle
- Maximum sensitivity and accuracy are ensured by the jeweled movement in conjunction with the precision gears and pinions
- Box type protective housing
- Constant measuring force
- Measuring spindle can be retracted with either a screw in cable release or with a lifting knob
- **Package contains:** cable release, case

### Applications:

- Very clear, reliable and fatigue-free readings due to extra-large display
- Ideal for test stations at which high volume production parts are measured or where the display can only be read from a distance
- For use in a stable measuring table. We recommend: MarStand 824 GT measuring table
- M2.5 thread on end of measuring pin for optional standard anvils



### TECHNICAL DATA

Order no.	4338100	4339100
Type	1000 A	1000 B
Measuring range	mm ± 0.12	± 0.05
Scale graduation value	µm	1
Figure on dial face	120–0–120	50–0–50
Error limit $G_e$	µm	1.5
Error limit $G_{ges}$	µm	2
Error limit $G_t$	µm	0.7
Measuring value hysteresis $f_u$	µm	1
Repeatability $f_w$	µm	0.5
Standard	Factory standard	
Free stroke	mm	4
Measuring force	N	3.5
Scale diameter	mm	110
Dial color	Yellow	

Order no.	Mounting shaft
	mm
4338100	28
4339100	28

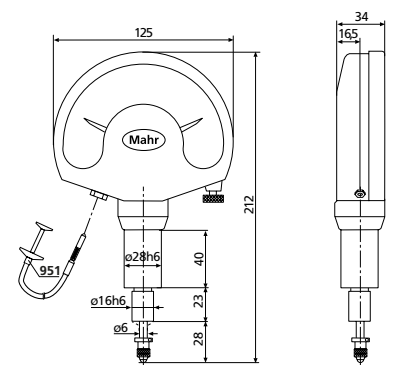

### ACCESSORIES

Order no.	Description	Type
4362001	Contact point, steel ball	921
4362002	Contact point, ruby ball	921 R
4372000	Cable release (250 mm)	951
4338008	Rubber bellows for 1000 A/B	

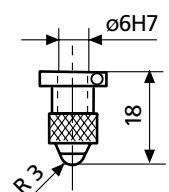

921/921R