

### FEATURES

- Large, high contrast dial face
- Adjustable tolerance markers
- Lockable fine adjustment screw
- Shockproof movement
- Mounting shank and measuring spindle are both made of hardened stainless steel
- Measuring spindle is mounted in a high precision ball guide for minimal hysteresis
- Resistant to lateral forces (side play) acting on the measuring spindle
- Maximum sensitivity and accuracy are ensured by the jeweled movement in conjunction with the precision gears and pinions
- Box type protective housing
- Constant measuring force
- Measuring spindle can be retracted with either a screw in cable release or with a lifting knob
- Package contains: case



### TECHNICAL DATA

Order no.	4332000	4332005
Type	1010	1010 T
Measuring range	mm	± 0.25
Readings		0.01
Figure on dial face		25–0–25
Error limit $G_e$	μm	7
Error limit $G_{ges}$	μm	8
Error limit $G_t$	μm	4
Measuring value hysteresis $f_u$	μm	2
Repeatability $f_w$	μm	2
Standard		Factory standard
Free stroke	mm	2.5
Measuring force	N	1
Scale diameter	mm	50
Dial color		White
IP protection category		IP 54

Order no.	Mounting shaft
	mm
4332000	8
4332005	8

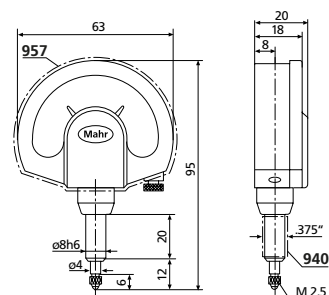

### ACCESSORIES

Order no.	Description	Type
4310103	Adapter bushing (.375" / 8 mm)	940
4372000	Cable release (250 mm)	951
4372030	Lifting knob	954
4373030	Splash guard cover	957
4375002	Lug back to mount on mounting shank 8h6 mm	963

