

# MarCal 16 EWR

## Digital caliper



### FUNCTIONS

- ON/OFF
- AUTO-ON / OFF
- RESET (set display to zero)
- mm/inch
- LOCK function (key lock)
- DATA (data transmission via connection cable)

### FEATURES

- High contrast digital display
- Locking screw above
- Lapped guideway
- Measuring blade for inside measurements
- Slide and beam made of hardened stainless steel
- Step measuring function
- Immediate measurements due to the Reference System
- Raised guideway for the protection of the scale
- Excellent resistance against dust, coolants and lubricants
- Dirt wipers are integrated in the slide
- **Software:** MarCom Professional free download: [www.mahr.com/marcom](http://www.mahr.com/marcom) (only for Mahr data cables and wireless systems with USB and RS-232 interface)
- **Digital height:** 8.5 mm
- **Data interface:** USB, Opto RS-232C, Digimatic
- **Energy supply:** Battery life approx. 3 years
- **Battery type:** CR 2032 (3V Lithium)
- **IP protection category:** IP 67
- **Package contains:** battery, instruction manual, case



### TECHNICAL DATA

Order no.	Type	Measuring range		Resolution	Error limit	Standard	Depth rod	Friction wheel
		mm	inch					
4103064	16 EWR	0-150	0-6"	0.01 / .0005"	0.03	DIN 862	round	
4103065	16 EWR	0-150	0-6"	0.01 / .0005"	0.03	DIN 862	round	•
4103066	16 EWR	0-150	0-6"	0.01 / .0005"	0.03	DIN 862	rectangular	
4103067	16 EWR	0-150	0-6"	0.01 / .0005"	0.03	DIN 862	rectangular	•
4103068	16 EWR	0-200	0-8"	0.01 / .0005"	0.03	DIN 862	rectangular	
4103069	16 EWR	0-200	0-8"	0.01 / .0005"	0.03	DIN 862	rectangular	•
4103070	16 EWR	0-300	0-12"	0.01 / .0005"	0.04	Factory standard		
4103071	16 EWR	0-300	0-12"	0.01 / .0005"	0.04	Factory standard		•

Order no.	a	b	c	d	e
	mm	mm	mm	mm	mm
4103064	10	40	16	235	16
4103065	10	40	16	235	16
4103066	10	40	16	235	16
4103067	10	40	16	235	16
4103068	10	50	19	285	16
4103069	10	50	19	285	16
4103070	14	64	19	388	16
4103071	14	64	19	388	16

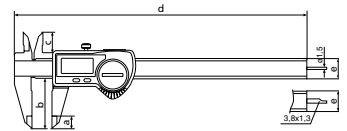

### ACCESSORIES

Order no.	Description	Type
4102020	Depth bridge (75 x 7 mm)	16 Em
4102357	16 EXu data connection cable USB (2 m)	16 EXu
4102410	Data connection cable RS232C (2 m)	16 EXr
4102915	Interface adapter with data cable Digimatic (2 m)	16 EWd

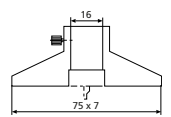

16 Em