

Marameter 838 EI

Digital inside quick probe



FUNCTIONS

- ON/OFF
- mm/inch
- TOL (enter tolerance limit values)
- ABS (display can be set to zero without losing reference to preset)
- DATA (in connection with data interface)

FEATURES

- High contrast analog and digital LCD
- Tolerance displayed via LED (red/green)
- **Data interface:** Digimatic, USB, Bluetooth (optional accessory)
- **Energy supply:** Battery operation (2x 1.5V AAA)
- **IP protection category:** IP 67
- **Package contains:** instruction manual, battery, test certificate

Applications:

- Specified measuring programs according to application
- Absolute/relative measuring program

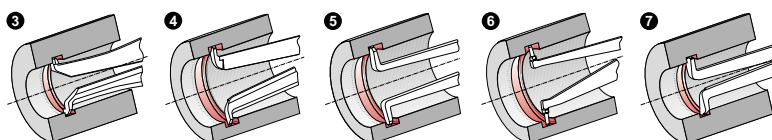

TECHNICAL DATA

| Order no. | 4495460 | 4495461 | 4495462 | 4495463 | 4495464 | 4495465 | 4495468 | 4495469 | 4495470 |
|---------------------------------|--|---------|---------|-----------|---------|---------|---------|-----------|---------|
| Type | 838 EI | | | | | | | | |
| Measuring range | mm 5 – 15 | 10 – 30 | 20 – 40 | 30 – 50 | 40 – 60 | 50 – 70 | 13 – 43 | 30 – 60 | 50 – 80 |
| Resolution | mm 0.001, 0.002, 0.005, 0.01, 0.02, 0.05 | | | | | | | | |
| Measuring depth | mm 35 | | | 85 | | | 127 | | 132 |
| Error limit | mm 0.015 | | | 0.03 | | | | 0.04 | |
| Repeatability | mm 0.005 | | | 0.01 | | | | 0.02 | |
| Groove depth | mm 2.3 | 5.2 | | 7 | | 8.3 | 5.7 | 6.2 | 8.3 |
| Groove width | mm 0.8 | | | 1.2 | | | 1.6 | 1.8 | 2.4 |
| Form of measuring contacts | | 4 | | 5 | | 6 | 4 | | 6 |
| Measuring contact ball diameter | mm 0.6 | | | 1 | | | 1.3 | 1.5 | 2 |
| Measuring force | N 0.8 – 1.2 | | | 1.1 – 1.6 | | | | 1.2 – 1.7 | |
| Bluetooth Option | • | | | | | | | | |

| Order no. | A | B | D | Hb | Hf | L |
|-----------|-----|------|-----|------|------|-----|
| | mm | mm | mm | mm | mm | mm |
| 4495460 | 2.3 | 0.80 | 0.6 | 2.5 | 2.5 | 35 |
| 4495461 | 5.2 | 1.20 | 1 | 5.4 | 5.4 | 85 |
| 4495462 | 7 | 1.20 | 1 | 7.3 | 7.3 | 85 |
| 4495463 | 7 | 1.20 | 1 | 7.3 | 7.3 | 85 |
| 4495464 | 8.3 | 1.20 | 1 | 12.2 | 12.2 | 85 |
| 4495465 | 8.3 | 1.20 | 1 | 12.2 | 12.2 | 85 |
| 4495468 | 5.7 | 1.60 | 1.3 | 5.7 | 5.7 | 127 |
| 4495469 | 6.2 | 1.80 | 1.5 | 6.5 | 6.5 | 132 |
| 4495470 | 8.3 | 2.40 | 2 | 8.5 | 8.5 | 132 |

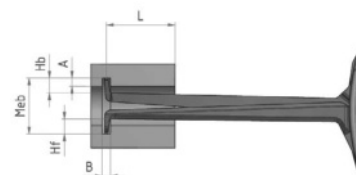

ACCESSORIES

| Order no. | Description | Type |
|-----------|--|------------|
| 4495083 | Interface adapter with data cable digimatic (1.5 m) | 838 di (A) |
| 4495079 | 838 USB interface adapter with data connection cable USB (1.5 m) | 838 USB |
| 4495036 | Bluetooth interface for 838 EI/EA, including USB dongle BT4.0 | 838 BT |



838 BT