

Bore Gauges for Small Holes

Series 511

These are bore gauges that automatically self-centre via a centring bridge.

They offer you the following benefits:

- A long plunger stroke gives you amazing accuracy.
- Interchangeable washers 0,5mm thick are supplied as standard accessories, so you can enable setting in small steps.
- Contact points are carbide (> 18 mm range), giving you high durability and wear resistance.
- A large grip reduces heat transfer from the operator by 50%.



Metric

No.	Range [mm]	Stroke of contact point [mm]	Graduation	Number of anvils	Measuring depth	No. Dial Indicator	Mass [g]
511-211-20	6 - 10	0,5	0,01 mm	9	50 mm	2046AB	255
511-204-20	10 - 18.5	0,6	0,01 mm	9	100 mm	2046AB	264
511-210-20	6 - 10	0,5	0,001 mm	9	50 mm	2109AB-10	255
511-203-20	10 - 18.5	0,6	0,001 mm	9	100 mm	2109AB-10	268

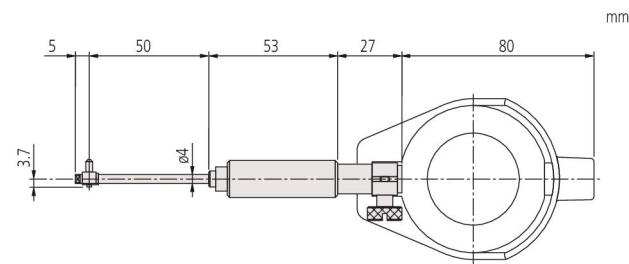

6-10 mm

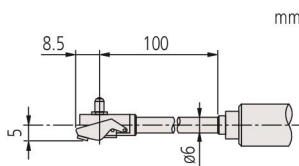

10-18,5 mm

Specifications

Accuracy	5 µm
Repeatability	2 µm
Delivered	Including box, dial indicator, plastic cover for indicator



543-310B

For details on indicators suitable for use with this instrument, refer to the Dial Gauges section.