

**Specifications**

Delivered

In a box

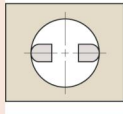
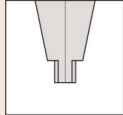
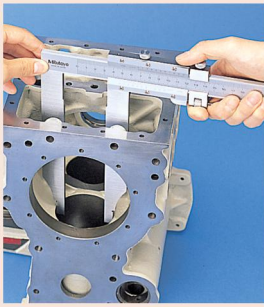

Rounded outside measuring surfaces for measuring inside dimensions

# Vernier Calipers with Long Jaws

## Series 534

These vernier calipers with long jaws come with or without fine adjustment and let you measure hard-to-reach features.

They offer you the following benefits:

- Long jaws enable you to measure hard-to-reach workpiece features.
- The top offset vernier scale allows you to directly read the inside dimensions without having to add the jaw blade width.

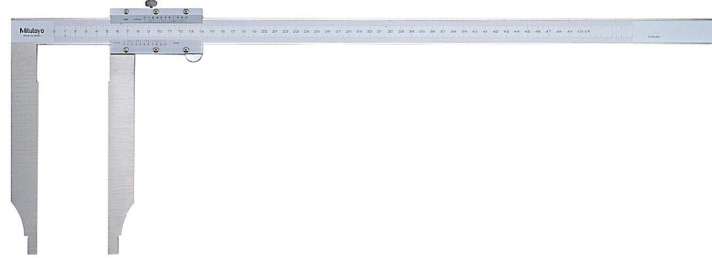

534-110

**Metric**

| No.     | Range [mm] | Inside measuring from | Accuracy | Graduation |
|---------|------------|-----------------------|----------|------------|
| 534-109 | 0 - 300    | 10,1 mm               | ±0,07 mm | 0,05 mm    |
| 534-113 | 0 - 300    | 10,1 mm               | ±0,04 mm | 0,02 mm    |
| 534-114 | 0 - 500    | 20,1 mm               | ±0,06 mm | 0,02 mm    |
| 534-110 | 0 - 500    | 20,1 mm               | ±0,13 mm | 0,05 mm    |
| 534-115 | 0 - 750    | 20,1 mm               | ±0,08 mm | 0,02 mm    |
| 534-116 | 0 - 1000   | 20,1 mm               | ±0,1 mm  | 0,02 mm    |

| No.     | Mass [g] | L [mm] | a [mm] | b [mm] | c [mm] | d [mm] | e [mm] | f [mm] | R [mm] |
|---------|----------|--------|--------|--------|--------|--------|--------|--------|--------|
| 534-109 | 400      | 445    | 110    | 90     | 12     | 20     | 7      | 3,8    | 5      |
| 534-113 | 460      | 445    | 110    | 90     | 12     | 20     | 7      | 3,8    | 5      |
| 534-114 | 1500     | 682    | 225    | 200    | 18,5   | 25     | 12     | 6      | 10     |
| 534-110 | 1400     | 682    | 225    | 200    | 18,5   | 25     | 12     | 6      | 10     |
| 534-115 | 2900     | 995    | 232    | 200    | 18,5   | 32     | 12     | 8      | 10     |
| 534-116 | 3500     | 1230   | 232    | 200    | 18,5   | 32     | 12     | 8      | 10     |

