

# Dial Indicator Depth Gauges

## Consumable spares

No.	Description
137413	Contact Element Needle, R=0,2mm, 17mm Length, Steel, Metric
21JAA224	Contact Element Ball Point, 17mm Length, Carbide, Metric
21JAA226	Contact Element Ball Point, 22mm Length, Carbide, Metric

## Series 7

This round base type dial indicator depth gauge offers you the following benefits:

- Round base type
- It has a hardened, precision ground and micro-lapped reference face on its base.



## Metric

Round base with indicator No. 2902AB

No.	Range [mm]	Accuracy	Stroke [mm]	Measuring force [N]	Base flatness [ $\mu\text{m}$ ]	Base (W x T)	Probe tip	Graduation	Mass [g]
7222A	0 - 10	$\pm 15 \mu\text{m}$	10	$\leq 1,4$	5	$\phi 16$	Needle, R = 0.2 mm (No. 137413)	0,01 mm	165
7223A	0 - 10	$\pm 15 \mu\text{m}$	10	$\leq 1,4$	5	$\phi 25$	Ball, R = 1.5 mm (No. 21JAA224)	0,01 mm	180
7224A	0 - 10	$\pm 15 \mu\text{m}$	10	$\leq 1,4$	5	$\phi 40$	Ball, R = 1.5 mm (No. 21JAA224)	0,01 mm	195

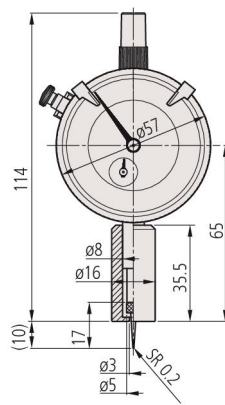

7222A

mm

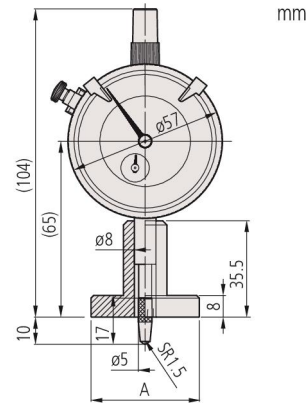

7223A A=  $\phi 25\text{mm}$   
7224A A=  $\phi 40\text{mm}$

mm