

**Specifications**

Setting accuracy at 45° ±15"

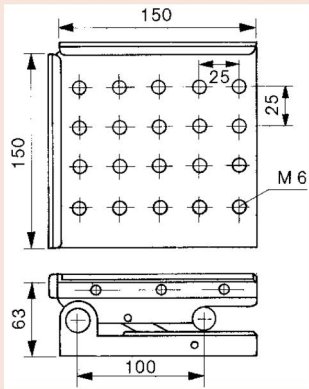

930-626

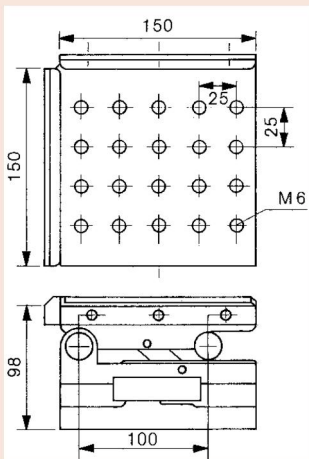

930-628

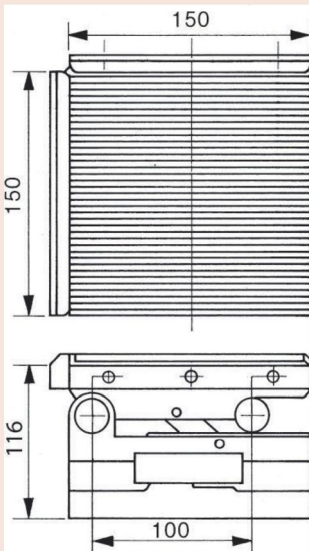

930-629

# Precision Sine Plates

## Series 930

- Sine bar style of auxiliary plate.
- It is made of tool steel, hardened and precision ground.
- Accurate angle setting is made by gauge blocks, max. 45°.
- 930-626 Work piece can be fixed on plate surface by tap holes and stoppers on side.
- 930-628 and 930-629 can set the angle at two directions which go straight angularly.
- 930-629 Permanently magnet chuck is adapted.



930-626



930-628

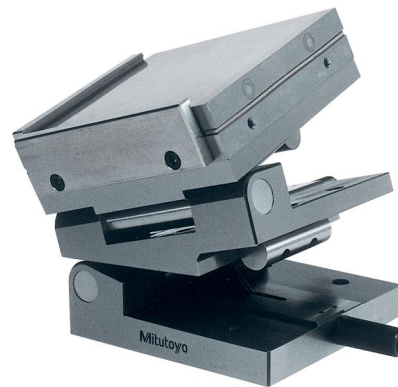

930-629

No.	Parallelism	Squareness [mm]	Remarks	Mass [kg]
930-626	0,002 mm / 100 mm	0,005 mm / 100 mm	With M6 clamping holes	7,6
930-628	0,002 mm / 100 mm	0,005 mm / 100 mm	Compound-axis type with angle in two directions With M6 clamping holes	11,3
930-629	0,002 mm / 100 mm	0,005 mm / 100 mm	Compound-axis type With lever-operated magnetic chuck	16,5